

# SM-TP

Two Platen Advanced Servo Drive  
Servomotor-driven Injection Moulding Machine  
Specifications from 700 to 6500 tons

Smallest Footprint

Largest Specs

Japanese-based designs

## Chen Hsong

📍 13-15 Dai Wang Street, Tai Po Industrial Estate, N.T., Hong Kong

✉ marketing@chenhsong.com

📞 +852 2665 3222

🌐 chenhsong.com

## 60 Years of Solid Foundation

The Chen Hsong Group was established in 1958 and has grown from a small machinery workshop to one of the largest manufacturers of injection moulding machines in the world. A full range of machines is produced with clamping forces from 20 tons to 6500 tons, with customers in over 80 countries worldwide.

Headquartered in Hong Kong, Chen Hsong owns a number of manufacturing facilities in China. The 560,000m<sup>2</sup> Chen Hsong Industrial Park in Shenzhen, China serves as the Group's flagship manufacturing, research and technology centre. Other major manufacturing plants are in Shunde, Ningbo, and Taiwan.

Chen Hsong's leading position in the industry is secured through relentless pursuit of technology advancement, manufacturing innovation, non-compromising service level and a mind for excellence.



## Insist on “True” Two-Platen Design

Shortest footprint - easy to fit into any factory





### SM700-TP-SVP/2

Clamping Unit	Clamping Force(Max.)	700																											
	Opening Force	70																											
	Opening Stroke	1,200-1,900																											
	Space Between Tie Bar(HxV)	1,020 x 1,020																											
	Mould Thickness(Min.-Max.)	400-1,100																											
	Maximum Daylight	2300																											
	Clamp Closing Speed(Max.)	45																											
	Clamp Opening Speed(Max.)	45																											
	Ejector Force(Max.)	22																											
	Ejector Stroke	280																											
Mould Register Hole	250																												

	J1	J2	K1	K2	N1	N2	P1	P2	Q1	Q2	A1	A2	R1	R2	B1	B2	C1	C2	D1	D2	E1	E2	F1	F2	G1	G2	H	
Shot Weight(PS)	g	1,968	2,314	2,604	3,087	3,430	4,322	4,754	5,658	6,172	7,244	7,847	9,101	9,801	11,251	13,180	17,939	21,002	27,431	31,431	39,780	44,843	55,362	61,166	74,011	81,034	96,437	106,081
Swept Volume	cm <sup>3</sup>	2,163	2,543	2,861	3,393	3,770	4,749	5,224	6,217	6,782	7,960	8,623	10,001	10,770	12,364	14,483	19,713	23,079	30,144	34,540	43,715	49,278	60,838	67,216	81,331	89,048	105,975	116,573
Screw Diameter	mm	83	90	90	98	98	110	110	120	120	130	140	140	150	150	175	175	200	200	225	225	250	250	275	275	300	300	300
Injection Pressure(Max.)	Mpa	187	159	184	155	184	146	184	155	184	157	180	155	180	157	180	132	160	123	160	126	160	130	160	132	160	134	160
Injection Stroke	mm	400		450		500		550		600		650		700		820		960		1,100		1,240		1,370		1,500		1,650
Screw Rotation Speed (Max.)	rpm	150		140		130		115		110		100		95		95		80		83		69		65		50		40
Injection Rate	cm <sup>3</sup> /s	560	658	635	753	720	907	885	1,053	1,045	1,226	1,215	1,409	1,390	1,596	1,390	1,892	1,790	2,339	2,210	2,797	2,720	3,358	3,120	3,775	4,310	5,129	4,965
Screw L/D Ratio		22.0	20.3	22.0	20.2	22.0	19.6	22.0	20.2	22.0	20.3	22.0	20.4	22.0	20.5	22.0	19.3	22.0	19.6	22.0	19.8	22.0	19.8	22.0	20.0	22.0	20.2	22.0
Nozzle Contact Force	ton	13.2																										

Power/Heating Unit	System Pressure	kgf/cm <sup>2</sup> 175																											
	Servo Motor Power	kW 84		96		108		132		168		180		204		204		240		300		360		480		660		720	
	Electrial Heating Power	kW 38		42		48		50		70		80		95		100		130		175		220		270		330		390	
	Temperature Heating Zone	7																											
	Oil Tank Capacity	L 1,650		1,700		1,750		2,250		2,350		2,700		3,300		3,850		4,150		5,950		7,400		8,650		11,000		12,500	

Others	Machine Dimensions(LxWxH)	m 9.2x2.9x2.5		9.3x2.9x2.5		9.4x2.9x2.5		10.2x2.9x2.5		10.9x2.9x2.5		11.0x2.9x2.5		11.3x2.9x2.5		11.3x2.9x2.5		12.4x2.9x2.5		13.2x2.9x2.5		14.8x2.9x2.5		16.2x2.9x2.5		18.6x2.9x2.5		20.6x2.9x2.5	
	Machine Weight(Approx.)	ton 28		29		31		33		35		37		38		39		46		54		64		77		94		114	

### SM850-TP-SVP/2

Clamping Unit	Clamping Force(Max.)	850																											
	Opening Force	85																											
	Opening Stroke	1,250-2,000																											
	Space Between Tie Bar(HxV)	1,170 x 1,170																											
	Mould Thickness(Min.-Max.)	450-1,200																											
	Maximum Daylight	2,450																											
	Clamp Closing Speed(Max.)	45																											
	Clamp Opening Speed(Max.)	45																											
	Ejector Force(Max.)	22																											
	Ejector Stroke	300																											
Mould Register Hole	250																												

	J1	J2	K1	K2	N1	N2	P1	P2	Q1	Q2	A1	A2	R1	R2	B1	B2	C1	C2	D1	D2	E1	E2	F1	F2	G1	G2	H	
Shot Weight(PS)	g	1,968	2,314	2,604	3,087	3,430	4,322	4,754	5,658	6,172	7,244	7,847	9,101	9,801	11,251	13,180	17,939	21,002	27,431	31,431	39,780	44,843	55,362	61,166	74,011	81,034	96,437	106,081
Swept Volume	cm <sup>3</sup>	2,163	2,543	2,861	3,393	3,770	4,749	5,224	6,217	6,782	7,960	8,623	10,001	10,770	12,364	14,483	19,713	23,079	30,144	34,540	43,715	49,278	60,838	67,216	81,331	89,048	105,975	116,573
Screw Diameter	mm	83	90	90	98	98	110	110	120	120	130	140	140	150	150	175	175	200	200	225	225	250	250	275	275	300	300	300
Injection Pressure(Max.)	Mpa	187	159	184	155	184	146	184	155	184	157	180	155	180	157	180	132	160	123	160	126	160	130	160	132	160	134	160
Injection Stroke	mm	400		450		500		550		600		650		700		820		960		1,100		1,240		1,370		1,500		1,650
Screw Rotation Speed (Max.)	rpm	150		140		130		115		110		100		95		95		80		83		69		65		50		40
Injection Rate	cm <sup>3</sup> /s	560	658	635	753	720	907	885	1,053	1,045	1,226	1,215	1,409	1,390	1,596	1,390	1,892	1,790	2,339	2,210	2,797	2,720	3,358	3,120	3,775	4,310	5,129	4,965
Screw L/D Ratio		22.0	20.3	22.0	20.2	22.0	19.6	22.0	20.2	22.0	20.3	22.0	20.4	22.0	20.5	22.0	19.3	22.0	19.6	22.0	19.8	22.0	19.8	22.0	20.0	22.0	20.2	22.0
Nozzle Contact Force	ton	13.2																										

Power/Heating Unit	System Pressure	kgf/cm <sup>2</sup> 175																											
	Servo Motor Power	kW 84		96		108		132		168		180		204		204		240		300		360		480		660		720	
	Electrial Heating Power	kW 38		42		48		50		70		80		95		100		130		175		220		270		330		390	
	Temperature Heating Zone	7																											
	Oil Tank Capacity	L 1,680		1,730		1,780		2,300		2,400		2,750		3,350		3,900		4,200		6,000		7,450		8,700		11,000		12,500	

Others	Machine Dimensions(LxWxH)	m 9.6x3.1x2.7		9.7x3.1x2.7		9.8x3.1x2.7		10.6x3.1x2.7		11.2x3.1x2.7		11.3x3.1x2.7		11.7x3.1x2.7		11.7x3.1x2.7		12.7x3.1x2.7		13.6x3.1x2.7		15.1x3.1x2.7		16.5x3.1x2.7		19.0x3.1x2.7		21.0x3.1x2.7	
	Machine Weight(Approx.)	ton 33		34		36		38		40		42		43		44		51		59		69		82		99		119	

### SM1050-TP-SVP/2

Clamping Unit	Clamping Force(Max.)	1,050																											
	Opening Force	85																											
	Opening Stroke	1,300-2,100																											
	Space Between Tie Bar(HxV)	1,280 x 1,280																											
	Mould Thickness(Min.-Max.)	500-1,300																											
	Maximum Daylight	2,600																											
	Clamp Closing Speed(Max.)	45																											
	Clamp Opening Speed(Max.)	45																											
	Ejector Force(Max.)	22																											
	Ejector Stroke	350																											
Mould Register Hole	250																												

	J1	J2	K1	K2	N1	N2	P1	P2	Q1	Q2	A1	A2	R1	R2	B1	B2	C1	C2	D1	D2	E1	E2	F1	F2	G1	G2	H	
Shot Weight(PS)	g	1,968	2,314	2,604	3,087	3,430	4,322	4,754	5,658	6,172	7,244	7,847	9,101	9,801	11,251	13,180	17,939	21,002	27,431	31,431	39,780	44,843	55,362	61,166	74,011	81,034	96,437	106,081
Swept Volume	cm <sup>3</sup>	2,163	2,543	2,861	3,393	3,770	4,749	5,224	6,217	6,782	7,960	8,623	10,001	10,770	12,364	14,483	19,713	23,079	30,144	34,540	43,715	49,278	60,838	67,216	81,331	89,048	105,975	116,573
Screw Diameter	mm	83	90	90	98	98	110	110	120	120	130	140	140	150	150	175	175	200	200	225	225	250	250	275	275	300	300	300
Injection Pressure(Max.)	Mpa	187	159	184	155	184	146	184	155	184	157	180	155	180	157	180	132	160	123	160	126	160	130	160	132	160	134	160
Injection Stroke	mm	400		450		500		550		600		650		700		820		960		1,100		1,240		1,370		1,500		1,650
Screw Rotation Speed (Max.)	rpm	150		140		130		115		110		100		95		95		80		83		69		65		50		40
Injection Rate	cm <sup>3</sup> /s	560	658	635	753	720	907	885	1,053	1,045	1,226	1,215	1,409	1,390	1,596	1,390	1,892	1,790	2,339	2,210	2,797	2,720	3,358	3,120	3,775	4,310	5,129	4,965
Screw L/D Ratio		22.0	20.3	22.0	20.2	22.0	19.6	22.0	20.2	22.0	20.3	22.0	20.4	22.0	20.5	22.0	19.3	22.0	19.6	22.0	19.8	22.0	19.8	22.0	20.0	22.0	20.2	22.0
Nozzle Contact Force	ton	13.2																										

Power/Heating Unit	System Pressure	kgf/cm <sup>2</sup> 175																											
	Servo Motor Power	kW 84		96		108		132		168		180		204		204		240		300		360		480		660		720	
	Electrial Heating Power	kW 38		42		48		50		70		80		95		100		130		175		220		270		330		390	
	Temperature Heating Zone	7																											
	Oil Tank Capacity	L 1,700		1,750		1,800		2,300		2,400		2,750		3,350		3,900		4,200		6,000		7,450		8,700		11,000		12,500	

Others	Machine Dimensions(LxWxH)	m 9.9x3.3x2.8		10.0x3.3x2.8		10.1x3.3x2.8		10.8x3.3x2.8		11.5x3.3x2.8		11.6x3.3x2.8		12.0x3.3x2.8		12.0x3.3x2.8		13.0x3.3x2.8		13.9x3.3x2.8</	
--------	---------------------------	---------------	--	--------------	--	--------------	--	--------------	--	--------------	--	--------------	--	--------------	--	--------------	--	--------------	--	----------------	--

**SM1450-TP-SVP/2**

<b>Clamping Unit</b>	Clamping Force(Max.)	ton																												1,450																											
	Opening Force	ton																												125																											
	Opening Stroke	mm																												1,650 - 2,450																											
	Space Between Tie Bar(HxV)	mm																												1,470 X 1,370																											
	Mould Thickness(Min.-Max.)	mm																												550 - 1,350																											
	Maximum Daylight	mm																												3,000																											
	Clamp Closing Speed(Max.)	m/min																												45																											
	Clamp Opening Speed(Max.)	m/min																												45																											
	Ejector Force(Max.)	ton																												35																											
	Ejector Stroke	mm																												400																											
Mould Register Hole	mm																												250																												
		J1	J2	K1	K2	N1	N2	P1	P2	Q1	Q2	A1	A2	R1	R2	B1	B2	C1	C2	D1	D2	E1	E2	F1	F2	G1	G2	H																													
<b>Injection Unit</b>	Shot Weight(PS)	g	1,968	2,314	2,604	3,087	3,430	4,322	4,754	5,658	6,172	7,244	7,847	9,101	9,801	11,251	13,180	17,939	21,002	27,431	31,431	39,780	44,843	55,362	61,166	74,011	81,034	96,437	106,081																												
	Swept Volume	cm³	2,163	2,543	2,861	3,393	3,770	4,749	5,224	6,217	6,782	7,960	8,623	10,001	10,770	12,364	14,483	19,713	23,079	30,144	34,540	43,715	49,278	60,838	67,216	81,331	89,048	105,975	116,573																												
	Screw Diameter	mm	83	90	90	98	98	110	110	120	120	130	130	140	140	150	150	175	175	200	200	225	225	250	250	275	275	300	300																												
	Injection Pressure(Max.)	Mpa	187	159	184	155	184	146	184	155	184	157	180	155	180	157	180	132	160	123	160	126	160	130	160	132	160	134	160																												
	Injection Stroke	mm	400		450		500		550		600		650		700		820		960		1,100		1,240		1,370		1,500		1,650																												
	Screw Rotation Speed (Max.)	rpm	150		140		130		115		110		100		95		80		83		69		65		60		50		40																												
	Injection Rate	cm³/s	560	658	635	753	720	907	885	1,053	1,045	1,226	1,215	1,409	1,390	1,596	1,390	1,892	1,790	2,339	2,210	2,797	2,720	3,358	3,120	3,775	4,310	5,129	4,965																												
	Screw L/D Ratio		22.0	20.3	22.0	20.2	22.0	19.6	22.0	20.2	22.0	20.3	22.0	20.4	22.0	20.5	22.0	18.9	22.0	19.3	22.0	19.6	22.0	19.8	22.0	20.0	22.0	20.2	22.0																												
	Nozzle Contact Force	ton	13.2																																																						
	<b>Power/Heating Unit</b>	System Pressure	kgf/cm²	175																																																					
Servo Motor Power		kW	84	96	108	132	168	180	204	204	240	300	360	480	660	720																																									
Electrical Heating Power		kW	38	42	48	50	70	80	95	100	130	175	220	270	330	390																																									
Temperature Heating Zone			7																																																						
Oil Tank Capacity		L	1,750	1,800	1,850	2,300	2,400	2,750	3,350	3,900	4,200	6,000	7,450	8,700	11,000	12,500																																									
<b>Others</b>	Machine Dimensions(LxWxH)	m	10.6x3.75x3.15	10.7x3.75x3.15	10.8x3.75x3.15	11.6x3.75x3.15	12.2x3.75x3.15	12.3x3.75x3.15	12.7x3.75x3.15	12.7x3.75x3.15	12.7x3.75x3.15	13.7x3.75x3.15	14.6x3.75x3.15	16.1x3.75x3.15	17.5x3.75x3.15	20.0x3.75x3.15	22.0x3.75x3.15																																								
	Machine Weight(Approx.)	ton	54	55	57	59	61	63	64	65	72	80	90	103	120	140																																									

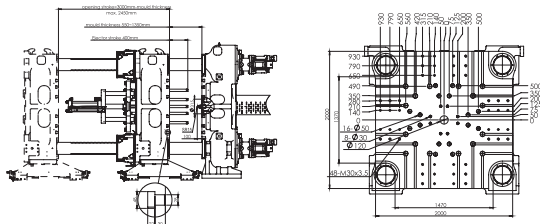

**SM1900-TP-SVP/2**

<b>Clamping Unit</b>	Clamping Force(Max.)	ton																												1,900																											
	Opening Force	ton																												165																											
	Opening Stroke	mm																												1,700 - 2,500																											
	Space Between Tie Bar(HxV)	mm																												1,670 X 1,550																											
	Mould Thickness(Min.-Max.)	mm																												700 - 1,500																											
	Maximum Daylight	mm																												3,200																											
	Clamp Closing Speed(Max.)	m/min																												45																											
	Clamp Opening Speed(Max.)	m/min																												45																											
	Ejector Force(Max.)	ton																												45																											
	Ejector Stroke	mm																												450																											
Mould Register Hole	mm																												315																												
		J1	J2	K1	K2	N1	N2	P1	P2	Q1	Q2	A1	A2	R1	R2	B1	B2	C1	C2	D1	D2	E1	E2	F1	F2	G1	G2	H																													
<b>Injection Unit</b>	Shot Weight(PS)	g	1,968	2,314	2,604	3,087	3,430	4,322	4,754	5,658	6,172	7,244	7,847	9,101	9,801	11,251	13,180	17,939	21,002	27,431	31,431	39,780	44,843	55,362	61,166	74,011	81,034	96,437	106,081																												
	Swept Volume	cm³	2,163	2,543	2,861	3,393	3,770	4,749	5,224	6,217	6,782	7,960	8,623	10,001	10,770	12,364	14,483	19,713	23,079	30,144	34,540	43,715	49,278	60,838	67,216	81,331	89,048	105,975	116,573																												
	Screw Diameter	mm	83	90	90	98	98	110	110	120	120	130	130	140	140	150	150	175	175	200	200	225	225	250	250	275	275	300	300																												
	Injection Pressure(Max.)	Mpa	187	159	184	155	184	146	184	155	184	157	180	155	180	157	180	132	160	123	160	126	160	130	160	132	160	134	160																												
	Injection Stroke	mm	400		450		500		550		600		650		700		820		960		1,100		1,240		1,370		1,500		1,650																												
	Screw Rotation Speed (Max.)	rpm	150		140		130		115		110		100		95		80		83		69		65		60		50		40																												
	Injection Rate	cm³/s	560	658	635	753	720	907	885	1,053	1,045	1,226	1,215	1,409	1,390	1,596	1,390	1,892	1,790	2,339	2,210	2,797	2,720	3,358	3,120	3,775	4,310	5,129	4,965																												
	Screw L/D Ratio		22.0	20.3	22.0	20.2	22.0	19.6	22.0	20.2	22.0	20.3	22.0	20.4	22.0	20.5	22.0	18.9	22.0	19.3	22.0	19.6	22.0	19.8	22.0	20.0	22.0	20.2	22.0																												
	Nozzle Contact Force	ton	13.2																																																						
	<b>Power/Heating Unit</b>	System Pressure	kgf/cm²	175																																																					
Servo Motor Power		kW	84	96	108	132	168	180	204	204	240	300	360	480	660	720																																									
Electrical Heating Power		kW	38	42	48	50	70	80	95	100	130	175	220	270	330	390																																									
Temperature Heating Zone			7																																																						
Oil Tank Capacity		L	1,800	1,850	1,900	2,400	2,500	2,850	3,450	4,000	4,300	6,100	7,550	8,800	11,100	12,600																																									
<b>Others</b>	Machine Dimensions(LxWxH)	m	10.8x4.2x3.5	10.9x4.2x3.5	11.0x4.2x3.5	11.8x4.2x3.5	12.4x4.2x3.5	12.5x4.2x3.5	12.9x4.2x3.5	12.9x4.2x3.5	14.0x4.2x3.5	14.8x4.2x3.5	16.4x4.2x3.5	17.7x4.2x3.5	20.2x4.2x3.5	22.2x4.2x3.5																																									
	Machine Weight(Approx.)	ton	69	70	72	74	76	78	79	80	87	95	105	118	135	155																																									

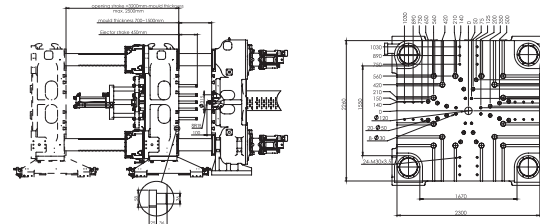

**SM1650-TP-SVP/2**

<b>Clamping Unit</b>	Clamping Force(Max.)	ton																												1,650																											
	Opening Force	ton																												165																											
	Opening Stroke	mm																												1,700 - 2,500																											
	Space Between Tie Bar(HxV)	mm																												1,570 X 1,470																											
	Mould Thickness(Min.-Max.)	mm																												600 - 1,400																											
	Maximum Daylight	mm																												3,100																											
	Clamp Closing Speed(Max.)	m/min																												45																											
	Clamp Opening Speed(Max.)	m/min																												45																											
	Ejector Force(Max.)	ton																												35																											
	Ejector Stroke	mm																												400																											
Mould Register Hole	mm																												315																												
		J1	J2	K1	K2	N1	N2	P1	P2	Q1	Q2	A1	A2	R1	R2	B1	B2	C1	C2	D1	D2	E1	E2	F1	F2	G1	G2	H																													
<b>Injection Unit</b>	Shot Weight(PS)	g	1,968	2,314	2,604	3,087	3,430	4,322	4,754	5,658	6,172	7,244	7,847	9,101	9,801	11,251	13,180	17,939	21,002	27,431	31,431	39,780	44,843	55,362	61,166	74,011	81,034	96,437	106,081																												
	Swept Volume	cm³	2,163	2,543	2,861	3,393	3,770	4,749	5,224	6,217	6,782	7,960	8,623	10,001	10,770	12,364	14,483	19,713	23,079	30,144	34,540	43,715	49,278	60,838	67,216	81,331	89,048	105,975	116,573																												
	Screw Diameter	mm	83	90	90	98	98	110	110	120	120	130	130	140	140	150	150	175	175	200	200	225	225	250	250	275	275	300	300																												
	Injection Pressure(Max.)	Mpa	187	159	184	155	184	146	184	155	184	157	180	155	180	157	180	132	160	123	160	126	160	130	160	132	160	134	160																												
	Injection Stroke	mm	400		450		500		550		600		650		700		820		960		1,100		1,240		1,370		1,500		1,650																												
	Screw Rotation Speed (Max.)	rpm	150		140		130		115		110		100		95		80		83		69		65		60		50		40																												
	Injection Rate	cm³/s	560	658	635	753	720	907	885	1,053	1,045	1,226	1,215	1,409	1,390	1,596	1,390	1,892	1,790	2,339	2,210	2,797	2,720	3,358	3,120	3,775	4,310	5,129	4,965																												
	Screw L/D Ratio		22.0	20.3	22.0	20.2	22.0	19.6	22.0	20.2	22.0	20.3	22.0	20.4	22.0	20.5	22.0	18.9	22.0	19.3	22.0	19.6	22.0	19.8	22.0	20.0	22.0	20.2	22.0																												
	Nozzle Contact Force	ton	13.2																																																						
	<b>Power/Heating Unit</b>	System Pressure	kgf/cm²	175																																																					
Servo Motor Power		kW	84	96	108	132	168	180	204	204	240	300	360	480	660	720																																									
Electrical Heating Power		kW	38	42	48	50	70	80	95	100	130	175	220	270	330	390																																									
Temperature Heating Zone			7																																																						
Oil Tank Capacity		L	1,780	1,830	1,880	2,350	2,450	2,800	3,400	3,950	4,250	6,050	7,500	8,750	11,050	12,550																																									
<b>Others</b>	Machine Dimensions(LxWxH)	m	10.6x3.8x3.3	10.7x3.8x3.3	10.8x3.8x3.3	11.6x3.8x3.3	12.2x3.8x3.3	12.3x3.8x3.3	12.7x3.8x3.3	12.7x3.8x3.3	13.7x3.8x3.3	14.6x3.8x3.3	16.1x3.8x3.3	17.5x3.8x3.3	20.0x3.8x3.3	22.0x3.8x3.3																																									
	Machine Weight(Approx.)	ton	59	60	62	64	66	68	69	70	77	85	95	108	125	145																																									

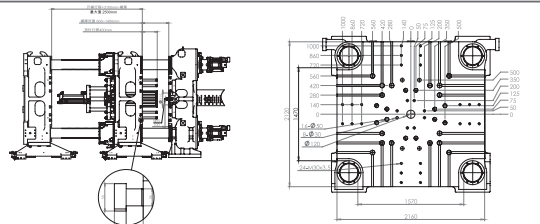

**SM2200-TP-SVP/2**

<b>Clamping Unit</b>	Clamping Force(Max.)	ton																												2,200																											
	Opening Force	ton																												210																											
	Opening Stroke	mm																												1,600 - 2,500																											
	Space Between Tie Bar(HxV)	mm																												1,820 X 1,520																											
	Mould Thickness(Min.-Max.)	mm																												700 - 1,600																											
	Maximum Daylight	mm																												3,200																											
	Clamp Closing Speed(Max.)	m/min																												45																											
	Clamp Opening Speed(Max.)	m/min																												45																											
	Ejector Force(Max.)	ton																												45																											
	Ejector Stroke	mm																												450																											
Mould Register Hole	mm																												315																												
		J1	J2	K1	K2	N1	N2	P1	P2	Q1	Q2	A1	A2	R1	R2	B1	B2	C1	C2	D1	D2	E1	E2	F1	F2	G1	G2	H																													
<b>Injection Unit</b>	Shot Weight(PS)	g	1,9																																																						





**SM6500-TP-SVP/2**

Clamping Unit	Clamping Force(Max.)	ton	6,500	
	Opening Force	ton	400	
	Opening Stroke	mm	2,700 - 3,900	
	Space Between Tie Bar(HxV)	mm	2,760 X 2,400	
	Mould Thickness(Min.-Max.)	mm	1,300 - 2,500	
	Maximum Daylight	mm	5,200	
	Clamp Closing Speed(Max.)	m/min	35	
	Clamp Opening Speed(Max.)	m/min	35	
	Ejector Force(Max.)	ton	80	
	Ejector Stroke	mm	650	
Mould Register Hole	mm	315		

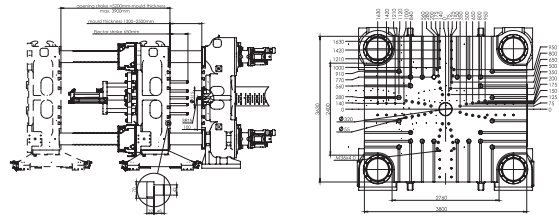

	J1	J2	K1	K2	N1	N2	P1	P2	Q1	Q2	A1	A2	R1	R2	B1	B2	C1	C2	D1	D2	E1	E2	F1	F2	G1	G2	H		
Shot Weight(PS)	g	1,968	2,314	2,604	3,087	3,430	4,322	4,754	5,658	6,172	7,244	7,847	9,101	9,801	11,251	13,180	17,939	21,002	27,431	31,431	39,780	44,843	55,362	61,166	74,011	81,034	96,437	106,081	
Swept Volume	cm³	2,163	2,543	2,861	3,393	3,770	4,749	5,224	6,217	6,782	7,960	8,623	10,001	10,770	12,364	14,483	19,713	23,079	30,144	34,540	43,715	49,278	60,838	67,216	81,331	89,048	105,975	116,573	
Screw Diameter	mm	83	90	90	98	98	110	110	120	130	130	140	140	150	150	175	175	200	200	225	225	250	275	275	300	300	300		
Injection Pressure(Max.)	Mpa	187	159	184	155	184	146	184	155	184	157	180	155	180	157	180	132	160	123	160	126	160	130	160	132	160	134	160	
Injection Stroke	mm	400		450		500		550		600		650		700		820		960		1,100		1,240		1,370		1,500		1,650	
Screw Rotation Speed (Max.)	rpm	150		140		130		115		110		100		95		95	80	83	69	65	50	60	50	60	47	50	40	40	
Injection Rate	cm³/s	560	658	635	753	720	907	885	1,053	1,045	1,226	1,215	1,409	1,390	1,596	1,390	1,892	1,790	2,339	2,210	2,797	2,720	3,358	3,120	3,775	4,310	5,129	4,965	
Screw L/D Ratio		22.0	20.3	22.0	20.2	22.0	19.6	22.0	20.2	22.0	20.3	22.0	20.4	22.0	20.5	22.0	18.9	22.0	19.3	22.0	19.6	22.0	19.8	22.0	20.0	22.0	20.2	22.0	
Nozzle Contact Force	ton	13.2																											
System Pressure	kgf/cm²	175																											
Servo Motor Power	kW	84		96		108		132		168		180		204		204		240		300		360		480		660		720	
Electrial Heating Power	kW	38		42		48		50		70		80		95		100		130		175		220		270		330		390	
Temperature Heating Zone		7																											
Oil Tank Capacity	L	2,400		2,450		2,500		2,950		3,050		3,400		4,000		4,550		4,850		6,650		8,100		9,350		11,650		13,150	
Machine Dimensions(LxWxH)	m	14.0x6.4x5.0		14.2x6.4x5.0		14.3x6.4x5.0		15.1x6.4x5.0		15.7x6.4x5.0		15.8x6.4x5.0		16.2x6.4x5.0		16.2x6.4x5.0		17.2x6.4x5.0		18.1x6.4x5.0		19.6x6.4x5.0		21.0x6.4x5.0		23.5x6.4x5.0		25.0x6.4x5.0	
Machine Weight(Approx.)	ton	284		285		287		289		291		293		294		295		302		310		320		333		350		370	

\* The technical parameters above are for reference only and discrepancies may arise in different circumstances. The company keeps upgrading the products and reserves the right to change the product specifications and parameters without prior notice. The final interpretation to the above specifications and parameters belongs to the company.

Standard

# Cutting-Edge Two-Platen Technology from Mitsubishi Cooperation

